

T.17S.R.6W.W.M.

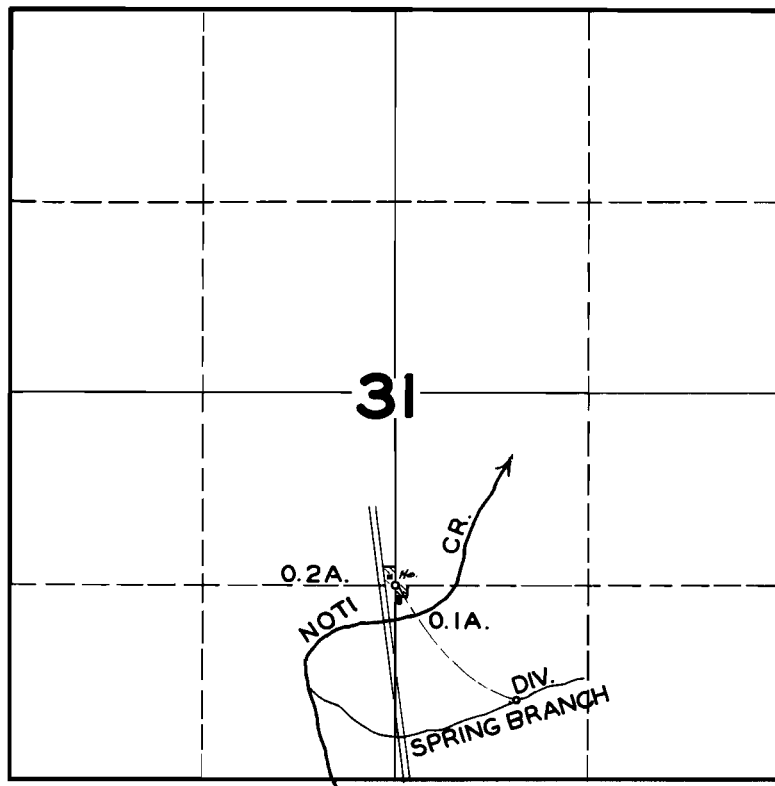

FINAL PROOF SURVEY
UNDER

Application No. **20447** Permit No. **15966**
IN NAME OF

JAMES L. GREGORY

Surveyed **JULY 21 1948**, by **JAS. E. BUNNELL**

STATE OF OREGON
COUNTY OF LANE
CERTIFICATE OF WATER RIGHT

This Is to Certify, That JAMES L. GREGORY

of Route 1, Box 696, Veneta, State of Oregon, has made proof to the satisfaction of the STATE ENGINEER of Oregon, of a right to the use of the waters of an unnamed stream a tributary of Noti Creek for the purpose of domestic use for one family and stock under Permit No. 15966 of the State Engineer, and that said right to the use of said waters has been perfected in accordance with the laws of Oregon; that the priority of the right hereby confirmed dates from September 6, 1944

that the amount of water to which such right is entitled and hereby confirmed, for the purposes aforesaid, is limited to an amount actually beneficially used for said purposes, and shall not exceed 0.02 cubic foot per second, being 0.01 cubic foot per second for domestic use and 0.01 cubic foot per second for stock,

or its equivalent in case of rotation, measured at the point of diversion from the stream. The point of diversion is located in the SW $\frac{1}{4}$ SE $\frac{1}{4}$, Section 31, Township 17 South, Range 6 West, W. M.

The amount of water used for irrigation, together with the amount secured under any other right existing for the same lands, shall be limited to _____ of one cubic foot per second per acre,

and shall conform to such reasonable rotation system as may be ordered by the proper state officer.

A description of the place of use under the right hereby confirmed, and to which such right is appurtenant, is as follows:

Domestic in NE $\frac{1}{4}$ SW $\frac{1}{4}$
Stock in SE $\frac{1}{4}$ SW $\frac{1}{4}$
Stock in SW $\frac{1}{4}$ SE $\frac{1}{4}$
Section 31

T. 17 S., R. 6 W., W. M.

Land on which water is to be used is a part of the property more explicitly described by the appropriator as follows: House and garden located in lot Beginning at the S.E. corner of the NE $\frac{1}{4}$ of the SW $\frac{1}{4}$ of Sec. 31 T. 17 S. R. 6 W. of W. M. thence N. along the east line of said NE $\frac{1}{4}$ of the SW $\frac{1}{4}$ 832 ft. more or less to the easterly line of the right of way line of the Noti-Vaughn County road; thence southeasterly along said easterly right of way line 843 feet more or less to the south line of the said northeast quarter of the southwest quarter; thence east along said south line 70 feet more or less to the place of beginning, being all of that portion of the above northeast quarter of the southwest quarter of sec. 31 lying east of the Noti-Vaughn County road and containing 1.64 acres more or less in Lane County, Oregon.

Stock trough and small garden located in plot Beginning at the Northeast corner of the Southeast quarter of Southwest quarter of Sec. 31, T. 17 S. R. 6 W. of the W. M. thence West to county Wagon Road, thence Southeast along said road to Noti-Creek, thence down said creek to place of beginning containing $\frac{1}{2}$ a. more or less, all in Lane County, Oregon.

The right to the use of the water for the purposes aforesaid is restricted to the lands or place of use herein described.

*WITNESS the signature of the State Engineer, affixed
this 28th day of February , 19 50.*

CHAS. E. STRICKLIN

State Engineer

Recorded in State Record of Water Right Certificates, Volume 14 , page 17045